

OREGON INVENTORY OF HISTORIC PROPERTIES
HISTORIC RESOURCE INVENTORY FORM

HISTORIC NAME: A.E. Davis Residence

DATE OF CONSTRUCTION: c. 1885

COMMON NAME: _____

ORIGINAL USE: Residence

ADDRESS: 702 Fourth Avenue

PRESENT USE: Residence

OWNER: John & Emma Renner, 702 Fourth Avenue

ARCH./BLDR.: Unknown

STYLE: Vernacular

T/R/S: 3-1E-1AA TAX LOT: 2600

BLDG. STRUC. DIST. SITE OBJ. (CIRCLE)

ADDITION: Plat of Canemah

THEME: Architecture, 19th Century

LOT: 1 BLOCK: 13 QUAD: Oregon City

PLAN TYPE/SHAPE: Rectangular with rear extension

NO. OF STORIES: 2

FOUNDATION MATERIAL: Wood

BASEMENT (Y/N): No

ROOF FORM & MATERIALS: Gable roof. Composition.

WALL CONSTRUCTION: Wood

STRUCTURAL FRAME: Stud

PRIMARY WINDOW TYPE: Some four-over-four windows. Some one-over-one windows.

SURFACING MATERIALS: Asbestos shingles.

DECORATIVE FEATURES: Pent-roof has square posts with decorative capitals and engaged

OTHER: pilasters at the house. One-story extension at rear.

CONDITION: EXCELLENT _____ GOOD _____ FAIR X DETERIORATED _____ MOVED _____ (date)

EXTERIOR ALTERATIONS/ADDITIONS (dated): Many four-over-four windows replaced with 1/1 panes, n.d. Asbestos shingles cover original siding, n.d. One-story extension at rear.

NOTEWORTHY LANDSCAPE FEATURES: None.

ASSOCIATED STRUCTURES: Shed.

KNOWN ARCHAEOLOGICAL FEATURES: None.

GEOGRAPHIC SETTING: Occupies a corner lot, which is a half-block in size, bounded by Fourth Avenue and unbuilt Fifth Avenue, unbuilt Apperson Street, and an unimproved alley. Also on this block is a vacant-quarter-block lot, and one residence.

STATEMENT OF SIGNIFICANCE: (Historical and/or architectural importance, dates, events, persons, contexts): A.E. Davis was an agent for the Oregon City Mills in the late 1880's. Despite alterations, this house retains its basic 1880's appearance, including the original porch and porch posts. It is significant for its age and its association with A.E. Davis, who, because of his position in the Mills, was an important person in Canemah. In the NR District, it is classified as a Primary structure.

SOURCES: Oregon Gazetteer, 1888. Sanborn Insurance Map, 1900, 1911, 1925. Clackamas County Tax Rolls, 1901. Pioneer National Title Company Records, Oregon City.

NEGATIVE NO: IV-A-15, 16

SLIDE NO: _____

RECORDED BY: Patricia Erigero

DATE: 1983

SHPO INVENTORY NO.: _____

OREGON INVENTORY OF HISTORIC PROPERTIES
HISTORIC RESOURCE INVENTORY FORM - TWO

NAME: A.E. Davis Residence

T/R/S: 3-1E-1AA TAX LOT 2600

ADDRESS: 702 Fourth Avenue

QUADRANGLE: Oregon City



NEGATIVE NO. IV-A-15, 16

SLIDE NO. _____

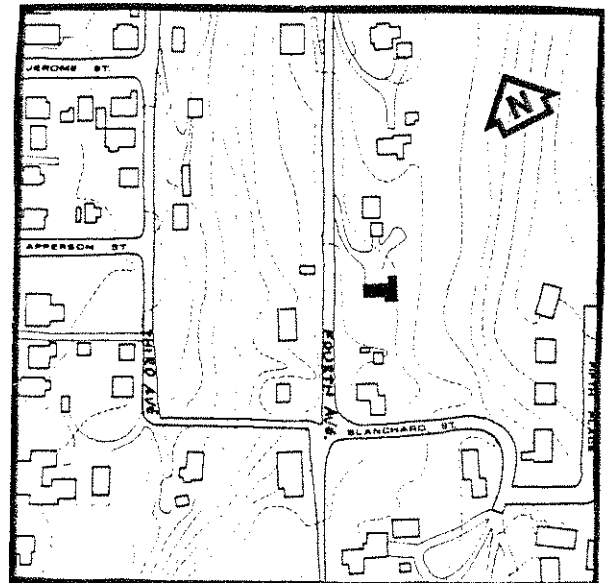
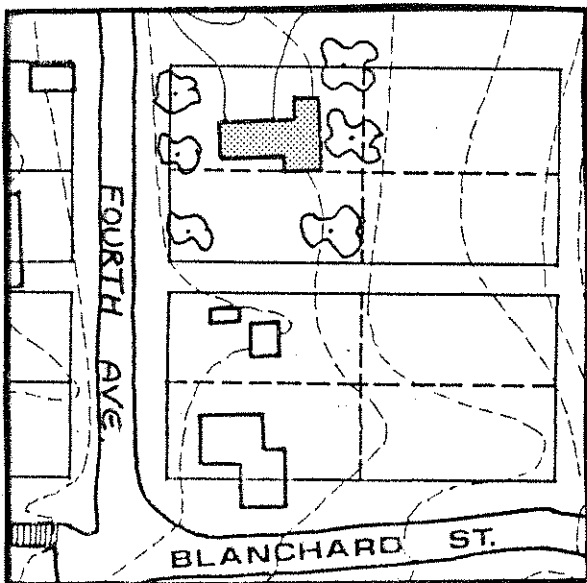

GRAPHIC AND PHOTO SOURCES: Base Map of Canemah. Oregon City Planning Department
Photograph, 1988.

SHPO INVENTORY NO.: _____