

TYPICAL ALLEY SECTION

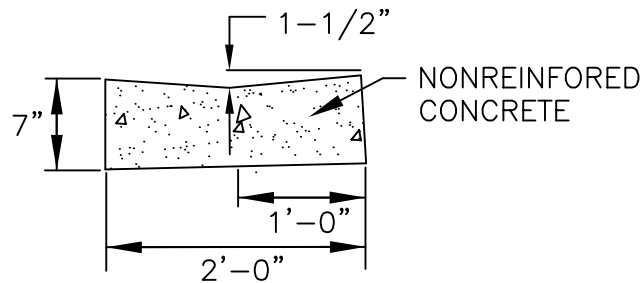

VALLEY CURB DETAIL (WHEN REQUIRED)

NOTES:

1. ASPHALTIC CONCRETE SHALL BE COMPACTED TO 92% OF RICE DENSITY.
2. AGGREGATE BASE CRUSHED ROCK. 8" DEPTH PER STREET DESIGN STANDARDS.
3. SUBGRADE AND BASEROCK SHALL BE COMPACTED TO 95% RELATIVE DENSITY PER AASHTO T-180.
4. PCC CURB SHALL BE 4000 PSI AT 28 DAYS.
5. "NO PARKING" SHALL BE POSTED THE ENTIRE LENGTH OF ALLEY DISTRICTS.
6. FIRE HYDRANTS WHEN REQUIRED ARE TO BE LOCATED OUTSIDE THE R-O-W IN A 5' BY 5' EASEMENT.

ALLEY AND RIGHT-OF-WAY WIDTHS

FUNCTIONAL CLASSIFICATION	RIGHT-OF-WAY	"A" PAVEMENT WIDTH	SIDEWALK WIDTH	PLANTER STRIP WIDTH
ALLEY REDISENTIAL DISTRICT	15'	7'	N/A	N/A
ALLEY-COMM. INDUSTRIAL DISTRICT	21'	10'	N/A	N/A

Public Works Standard Drawings

ALLEY SECTION

SCALE NTS

DATE JAN '23 REV.

ENGR. DW DRAWN KAE

DRAWING NO. 526

